

MATERIALS OF CONSTRUCTION: CARBON STEEL, BRASS				
Capacity:	x	Gallons		
Max Temp.:	200	F		
Max Press.:	300	PSI		
Weight:	5	Lbs.		
Voltage.:	x	VAC	x	Phs x Hz
FLA.:	x	amps		
AquaPhoenix Scientific, Inc. California Division 113 Viking Ave, Brea CA 92821 Phone: 714-257-9165 http://www.aquaphoenixsci.com Fax: 714-257-9215 info@aquaphoenixsci.com				
Date:	02/01/06	Scale:	NTS	Rev.: A
Description:	BYPASS/FILTER FEEDER ACCESSORIES			
Model:	AR			

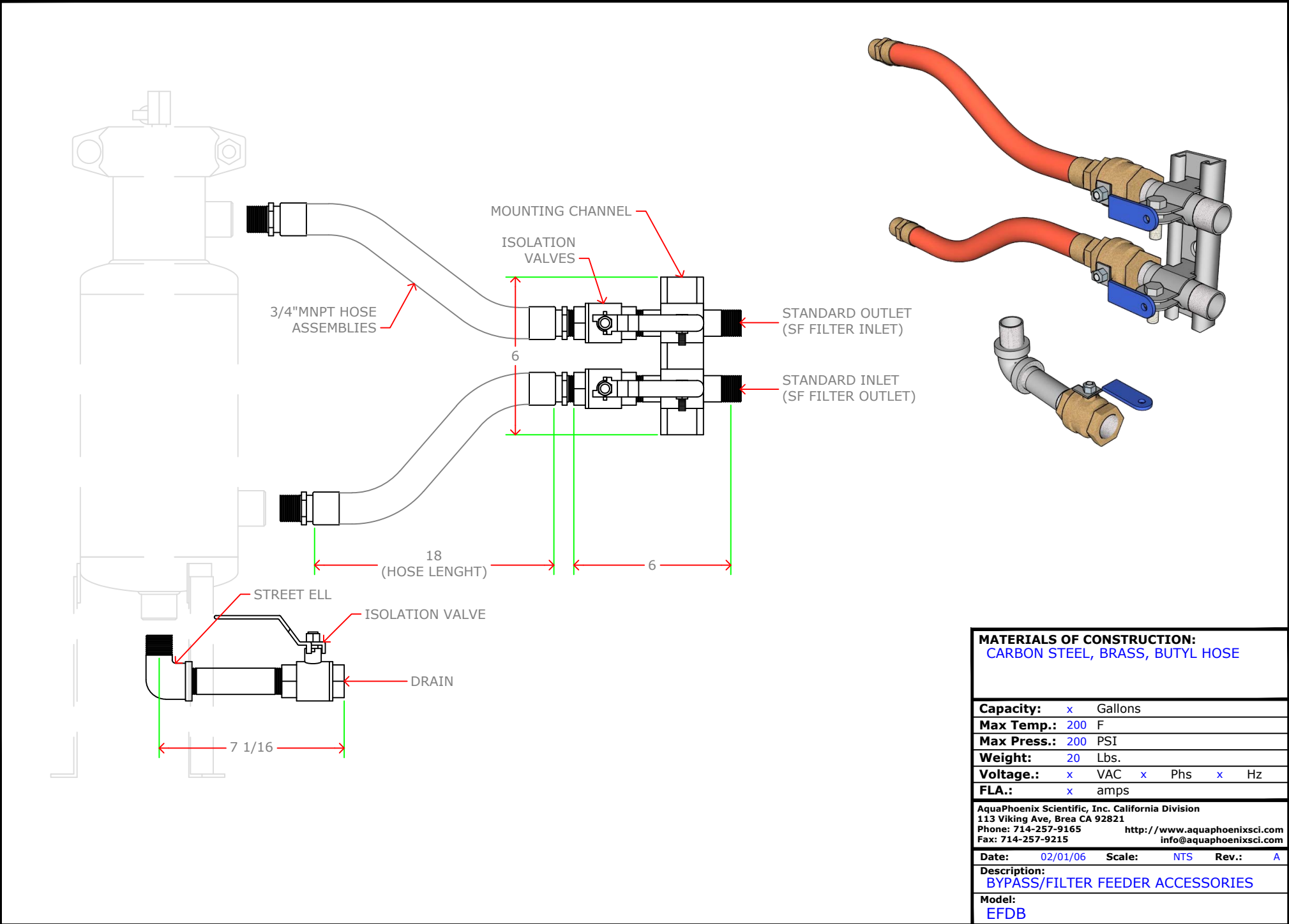

NOTICE: This drawing and it's contents are for the specific use of APS customers only. It is not to be duplicated or copied without expressed written consent. AquaPhoenix reserves the right to modify this drawing without notice.

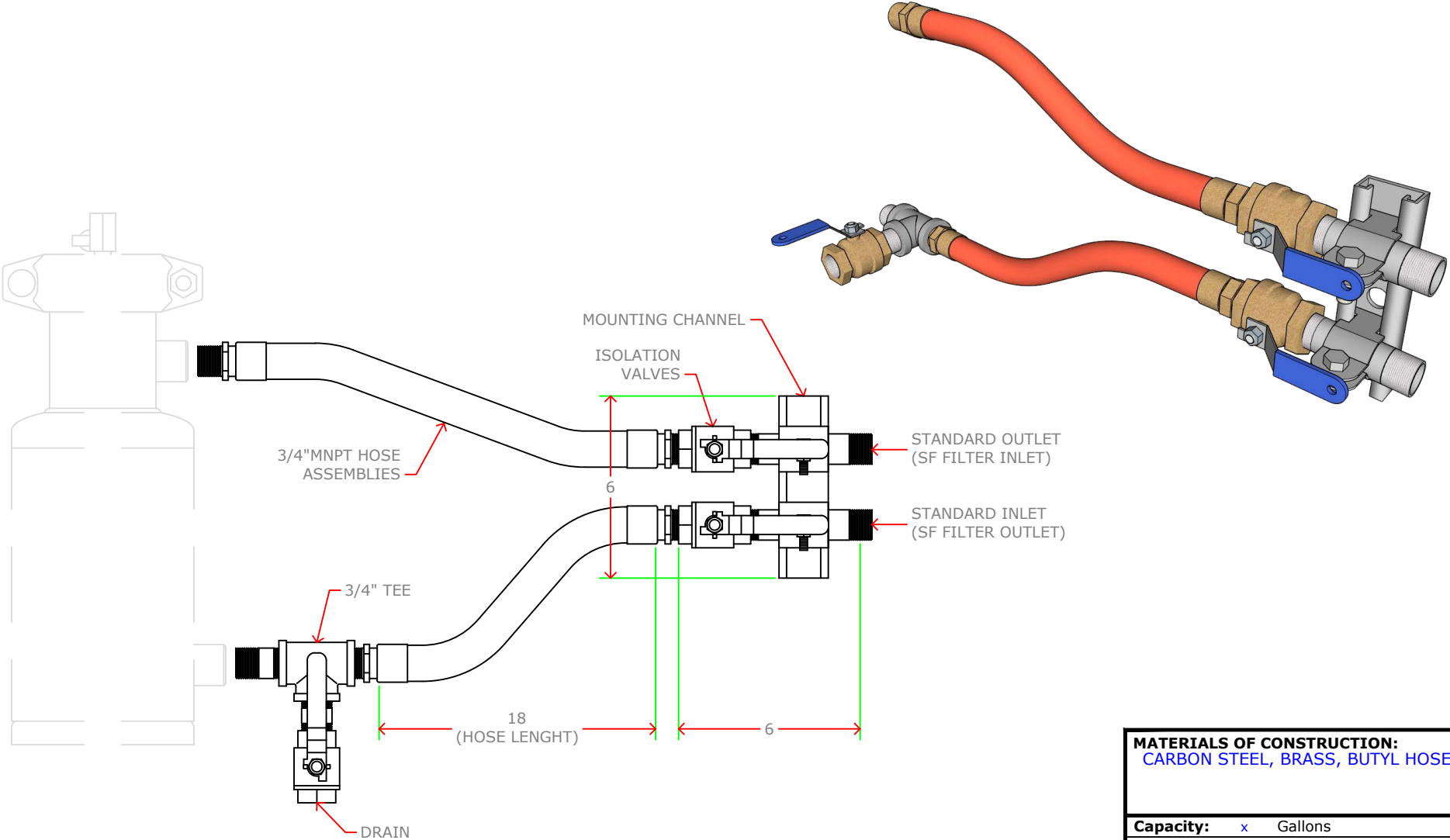

MATERIALS OF CONSTRUCTION: CARBON STEEL, BRASS, BUTYL HOSE					
Capacity:	x	Gallons			
Max Temp.:	200	F			
Max Press.:	200	PSI			
Weight:	x	Lbs.			
Voltage.:	x	VAC	x	Phs	x Hz
FLA.:	x	amps			
AquaPhoenix Scientific, Inc. California Division 113 Viking Ave, Brea CA 92821 Phone: 714-257-9165 http://www.aquaphoenixsci.com Fax: 714-257-9215 info@aquaphoenixsci.com					
Date:	02/01/06	Scale:	NTS	Rev.:	A
Description: BYPASS/FILTER FEEDER ACCESSORIES					
Model: EFFB					

NOTICE: This drawing and it's contents are for the specific use of APS customers only. It is not to be duplicated or copied without expressed written consent. AquaPhoenix reserves the right to modify this drawing without notice.

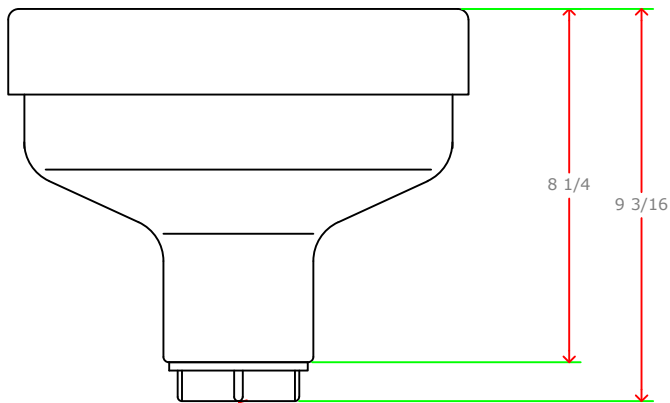

CHOICE OF CONNECTION
3/4" THRU 2" NPT OR
QC FOR BYPASS FEEDERS

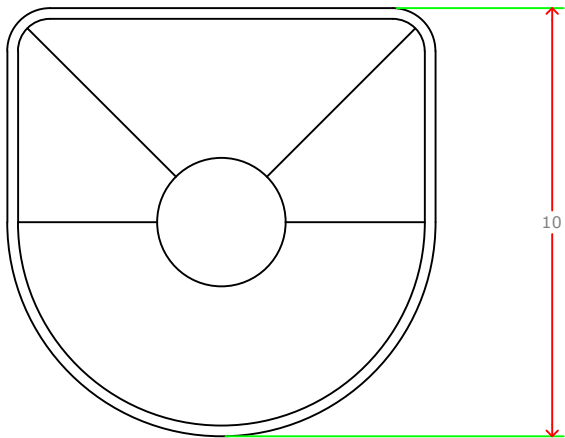

10" DUST COVER

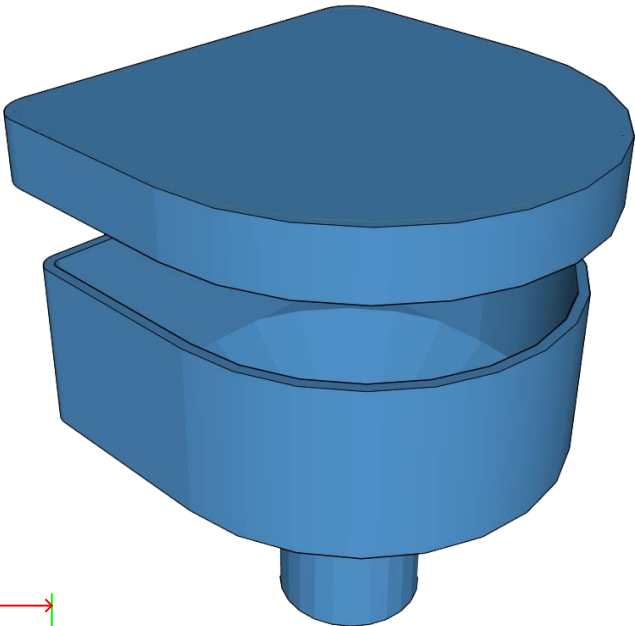
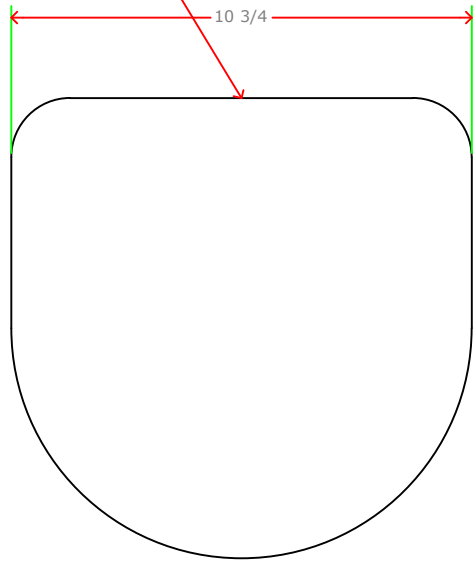

MATERIALS OF CONSTRUCTION:
POLYETHYLENE

Capacity:	x	Gallons
Max Temp.:	140	F
Max Press.:	0	PSI
Weight:	10	Lbs.
Voltage.:	x	VAC x Phs x Hz
FLA.:	x	amps

AquaPhoenix Scientific, Inc. California Division
113 Viking Ave, Brea CA 92821
Phone: 714-257-9165 <http://www.aquaphoenixsci.com>
Fax: 714-257-9215 info@aquaphoenixsci.com

Date: 02/01/06 Scale: NTS Rev.: A

Description:
BYPASS/FILTER FEEDER ACCESSORIES

Model:
FLPE

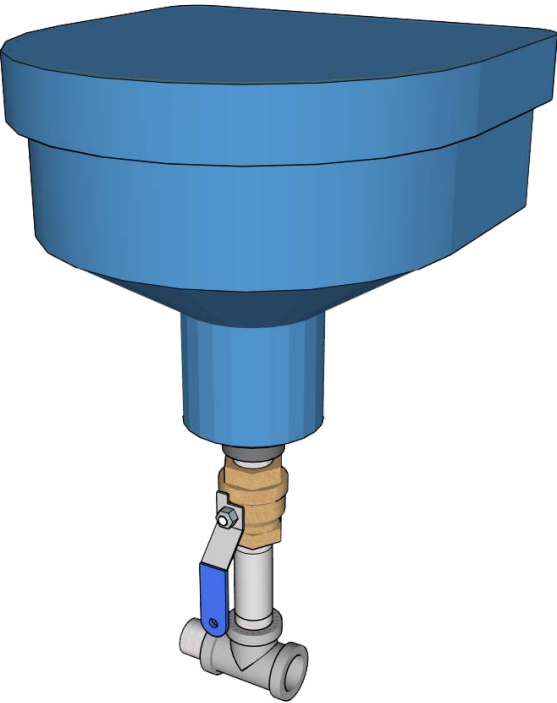
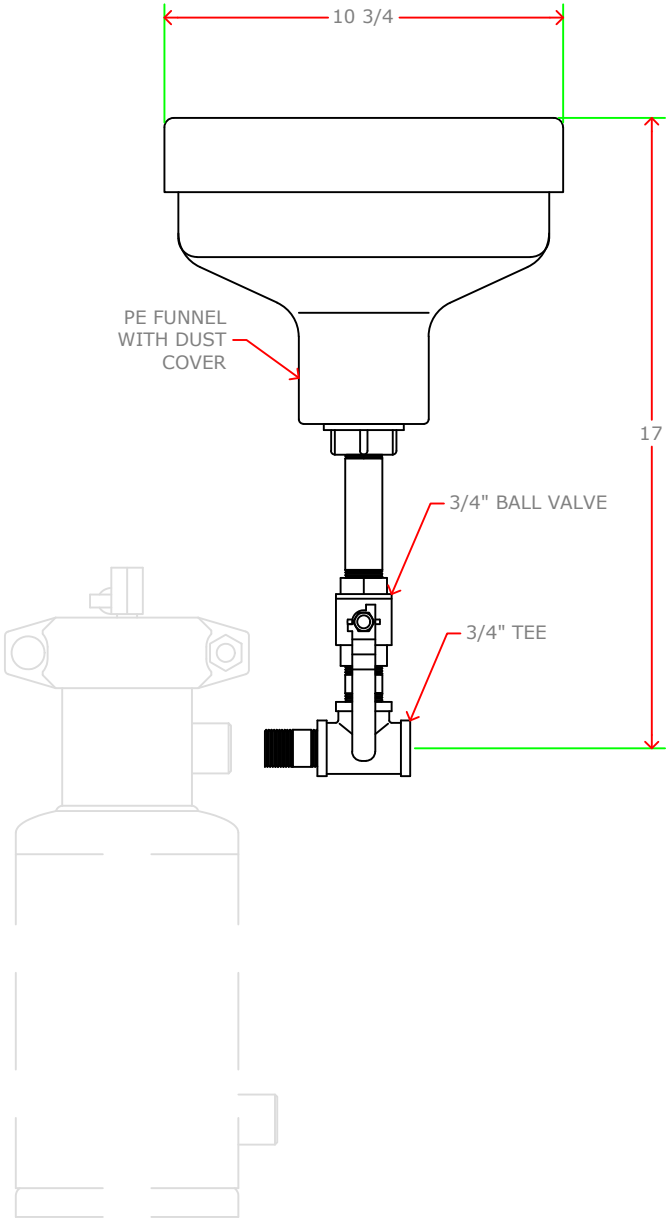

MATERIALS OF CONSTRUCTION: POLYETHYLENE, CARBON STEEL, BRASS									
Capacity:	x	Gallons							
Max Temp.:	200	F							
Max Press.:	300	PSI							
Weight:	25	Lbs.							
Voltage.:	x	VAC	x	Phs	x	Hz			
FLA.:	x	amps							
AquaPhoenix Scientific, Inc. California Division 113 Viking Ave, Brea CA 92821 Phone: 714-257-9165 http://www.aquaphoenixsci.com Fax: 714-257-9215 info@aquaphoenixsci.com									
Date:	02/01/06	Scale:	NTS		Rev.:	A			
Description: BYPASS/FILTER FEEDER ACCESSORIES									
Model: FLPEV									

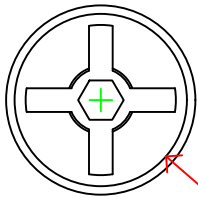

PRE-2016
PF20 (OLD STYLE)

2 3/4"

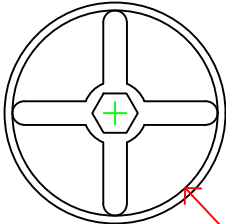

PF20 &
PF20/QC

3 1/4"

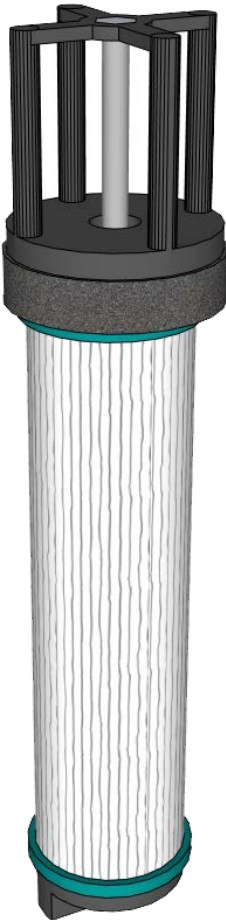
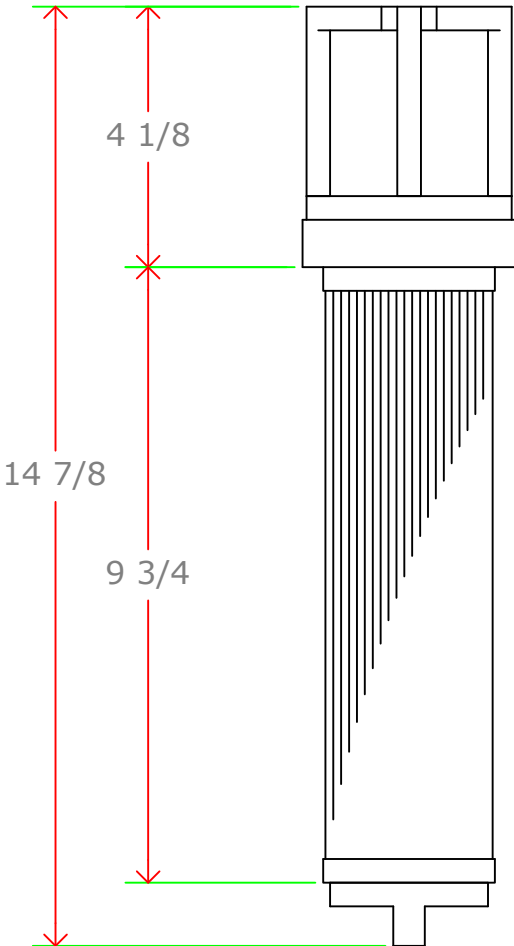
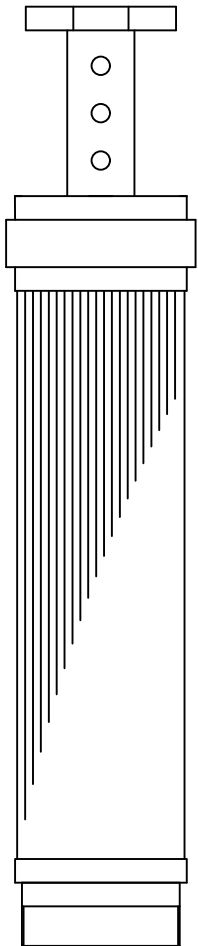

MATERIALS OF CONSTRUCTION:

x

Capacity: x Gallons

Max Temp.: 200 F

Max Press.: N/A PSI

Weight: 10 Lbs.

Voltage.: x VAC x Phs x Hz

FLA.: x amps

AquaPhoenix Scientific, Inc. California Division
113 Viking Ave, Brea CA 92821
Phone: 714-257-9165 <http://www.aquaphoenixsci.com>
Fax: 714-257-9215 info@aquaphoenixsci.com

Date: 02/01/06 **Scale:** NTS **Rev.:** A

Description:
BYPASS/FILTER FEEDER ACCESSORIES

Model:
PF20 & PF20/QC

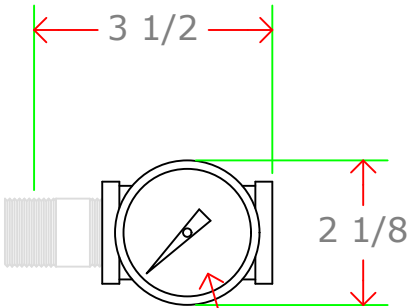
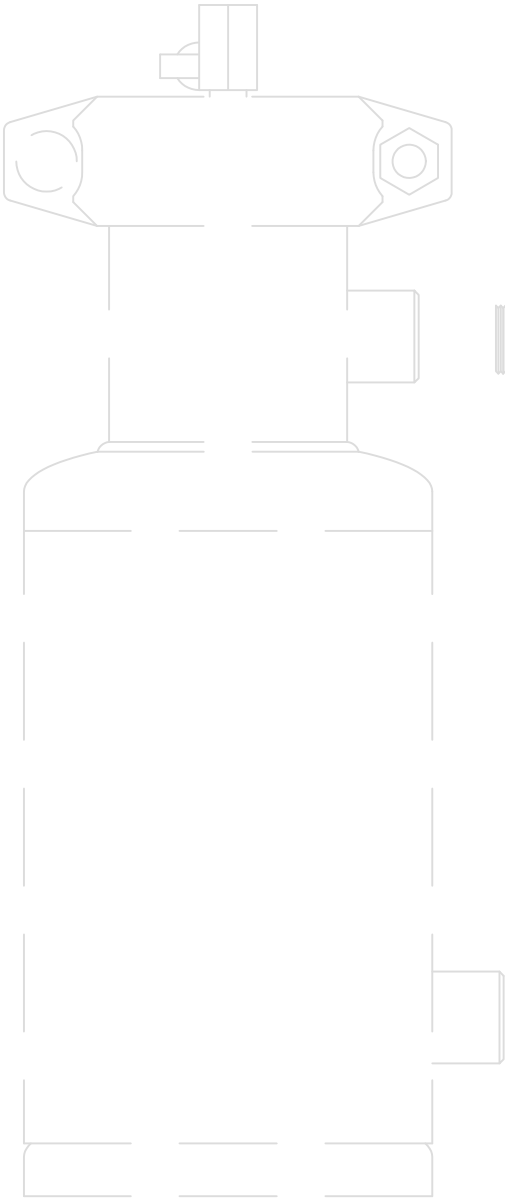

0-300PSI
GAUGE AND
INSTALLATION
TEE

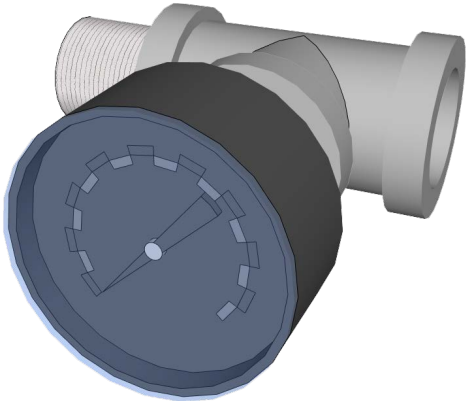

MATERIALS OF CONSTRUCTION:
CARBON STEEL, BRASS

Capacity:	x	Gallons				
Max Temp.:	200	F				
Max Press.:	300	PSI				
Weight:	5	Lbs.				
Voltage.:	x	VAC	x	Phs	x	Hz
FLA.:	x	amps				

AquaPhoenix Scientific, Inc. California Division
113 Viking Ave, Brea CA 92821
Phone: 714-257-9165 <http://www.aquaphoenixsci.com>
Fax: 714-257-9215 info@aquaphoenixsci.com

Date:	02/01/06	Scale:	NTS	Rev.:	A
Description:	BYPASS/FILTER FEEDER ACCESSORIES				
Model:	PG300				

NOTICE: This drawing and it's contents are for the specific use of APS customers only. It is not to be duplicated or copied without expressed written consent. AquaPhoenix reserves the right to modify this drawing without notice.

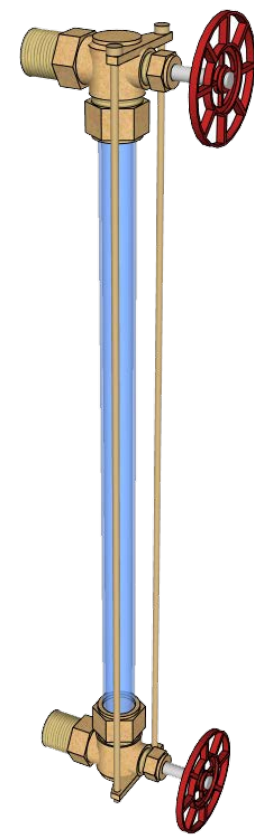
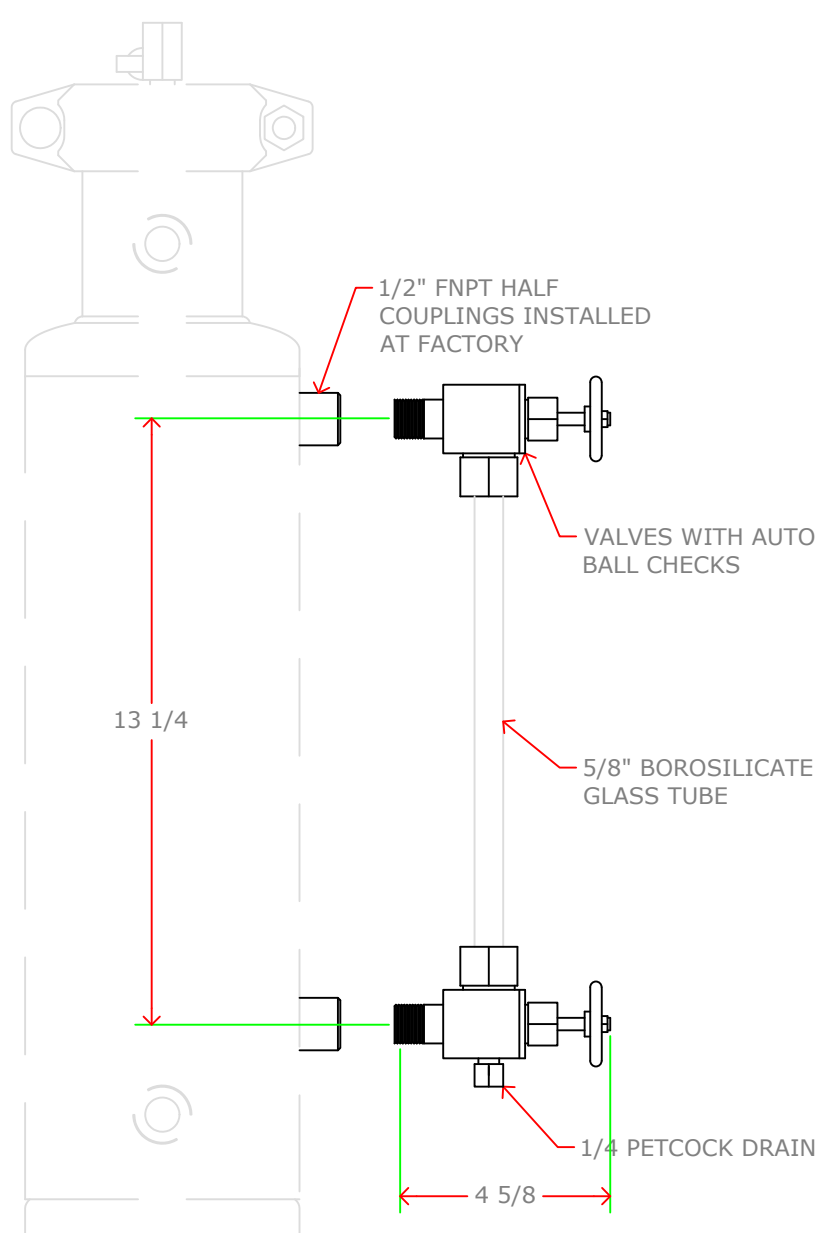

MATERIALS OF CONSTRUCTION:
BRASS, EPDM, TEFLON, GLASS

Capacity:	x	Gallons				
Max Temp.:	200	F				
Max Press.:	125	PSI				
Weight:	10	Lbs.				
Voltage.:	x	VAC	x	Phs	x	Hz
FLA.:	x	amps				
AquaPhoenix Scientific, Inc. California Division 113 Viking Ave, Brea CA 92821 Phone: 714-257-9165 http://www.aquaphoenixsci.com Fax: 714-257-9215 info@aquaphoenixsci.com						
Date:	02/01/06	Scale:	NTS	Rev.:	A	
Description: BYPASS/FILTER FEEDER ACCESSORIES						
Model: S125						

NOTICE: This drawing and it's contents are for the specific use of APS customers only. It is not to be duplicated or copied without expressed written consent. AquaPhoenix reserves the right to modify this drawing without notice.

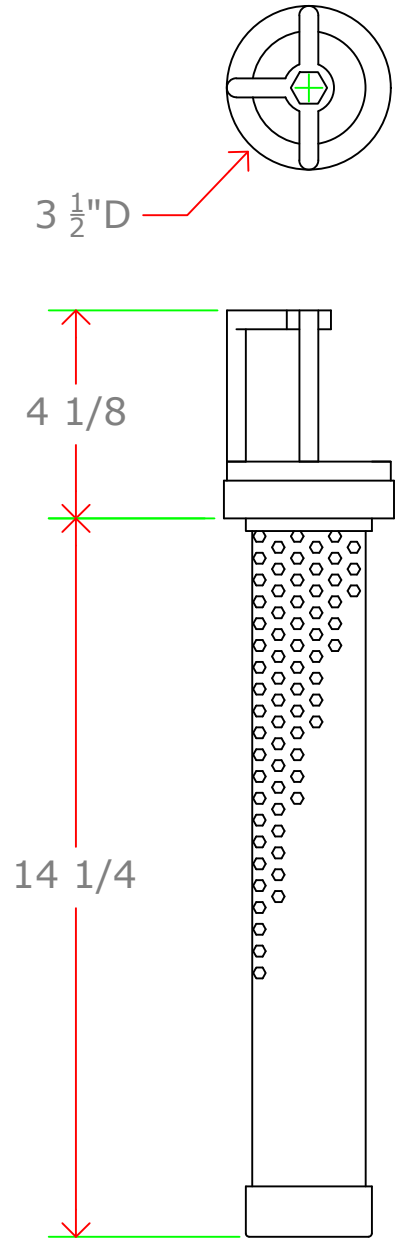

MATERIALS OF CONSTRUCTION:
POLYETHER FELT, RYTON, STAINLESS

Capacity:	x	Gallons
Max Temp.:	200	F
Max Press.:	N/A	PSI
Weight:	10	Lbs.
Voltage.:	x	VAC x Phs x Hz
FLA.:	x	amps

AquaPhoenix Scientific, Inc. California Division
113 Viking Ave, Brea CA 92821
Phone: 714-257-9165 <http://www.aquaphoenixsci.com>
Fax: 714-257-9215 info@aquaphoenixsci.com

Date: 02/01/06 Scale: NTS Rev.: A

Description:
BYPASS/FILTER FEEDER ACCESSORIES

Model:
SF25

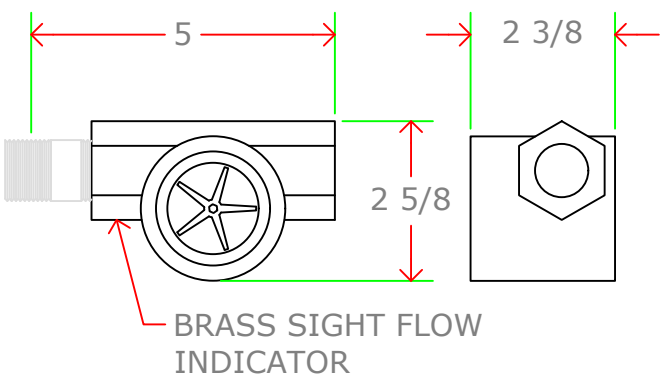
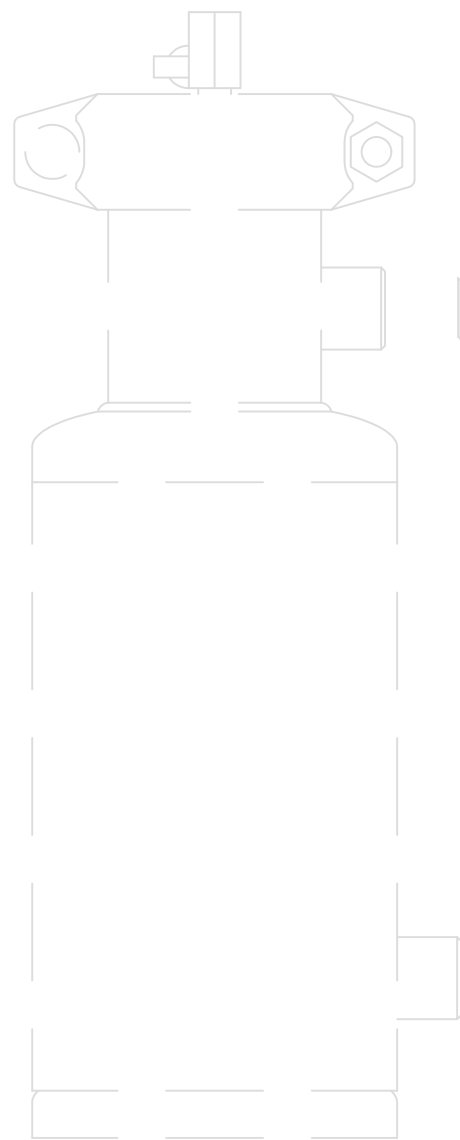

NOTE: SIGHT FLOW INDICATOR SHOULD BE INSTALLED ON OUTLET SIDE OF FEEDER. MOVE TO LOWER SIDE FITTING FOR SOCK FILTER APPLICATIONS.

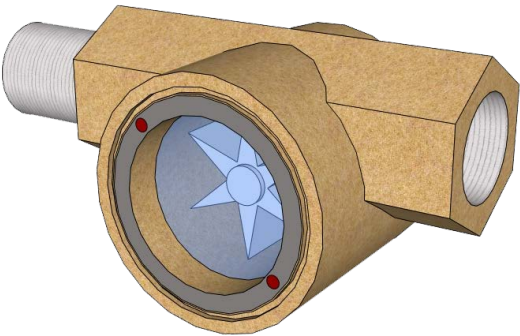

MATERIALS OF CONSTRUCTION: CARBON STEEL, BRASS, ABS				
Capacity:	x	Gallons		
Max Temp.:	200	F		
Max Press.:	125	PSI		
Weight:	8	Lbs.		
Voltage.:	x	VAC	x	Phs
			x	Hz
FLA.:	x	amps		
AquaPhoenix Scientific, Inc. California Division 113 Viking Ave, Brea CA 92821 Phone: 714-257-9165 http://www.aquaphoenixsci.com Fax: 714-257-9215 info@aquaphoenixsci.com				
Date:	02/01/06	Scale:	NTS	Rev.: A
Description: BYPASS/FILTER FEEDER ACCESSORIES				
Model: SFI-075-125				

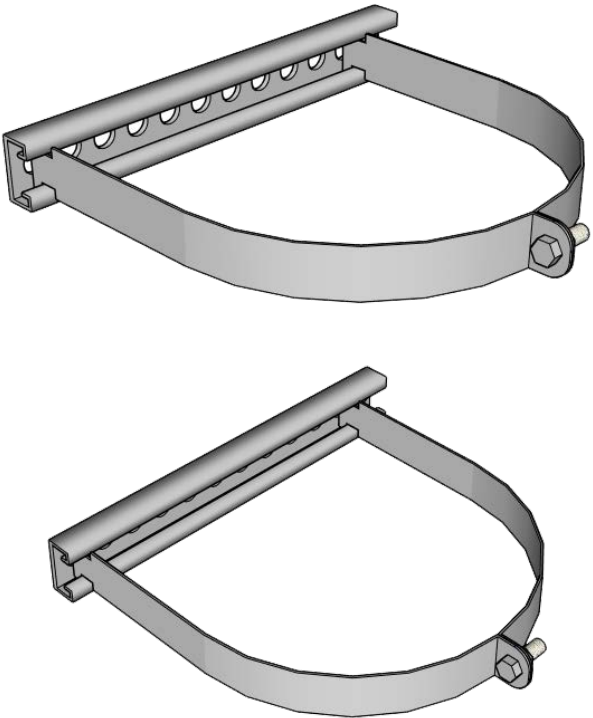
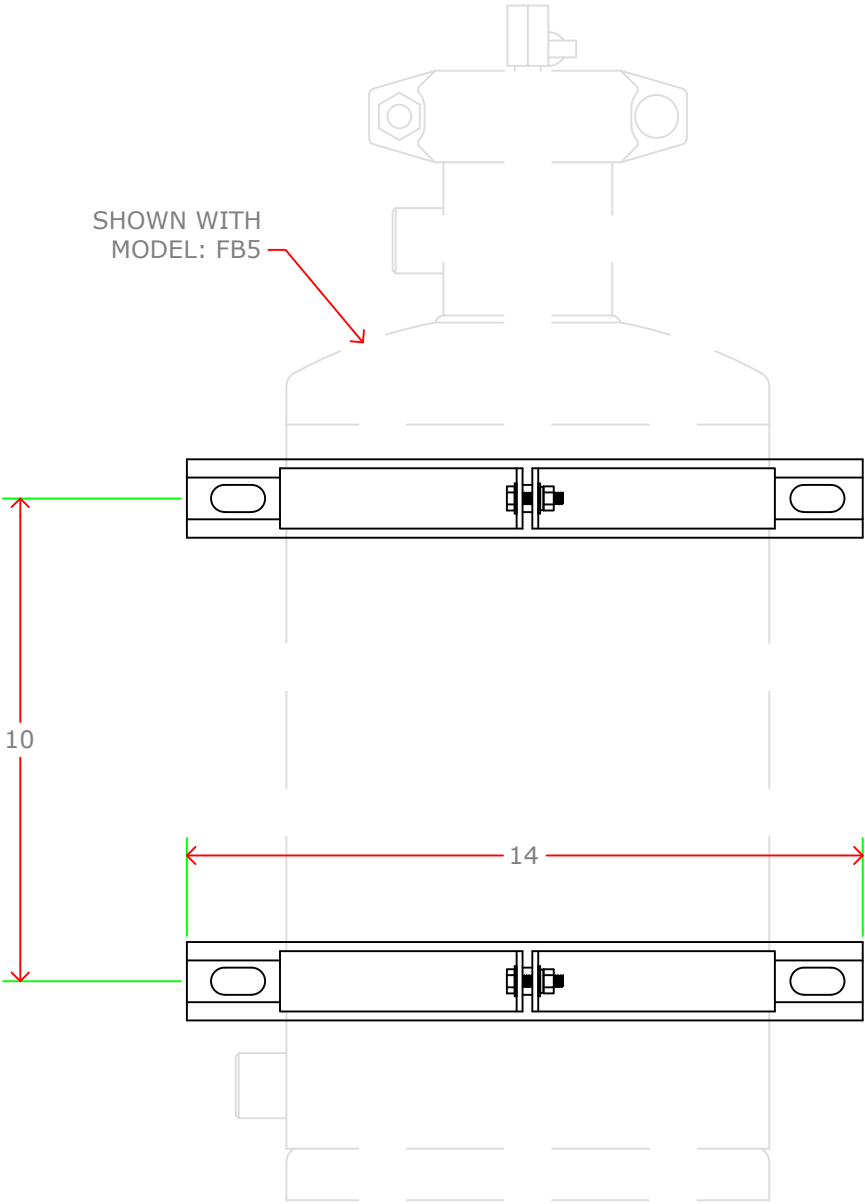

MATERIALS OF CONSTRUCTION: GALV PLATED CARBON STEEL				
Capacity:	x	Gallons		
Max Temp.:	x	F		
Max Press.:	x	PSI		
Weight:	25	Lbs.		
Voltage.:	x	VAC	x	Phs
FLA.:	x	amps	x	Hz
AquaPhoenix Scientific, Inc. California Division 113 Viking Ave, Brea CA 92821 Phone: 714-257-9165 http://www.aquaphoenixsci.com Fax: 714-257-9215 info@aquaphoenixsci.com				
Date:	02/01/06	Scale:	NTS	Rev.: A
Description: BYPASS/FILTER FEEDER ACCESSORIES				
Model: STRP06 & STRP10				

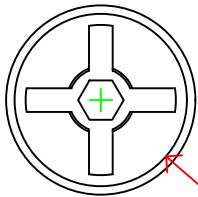

PRE-2016
PF20 (OLD STYLE)

2 3/4"

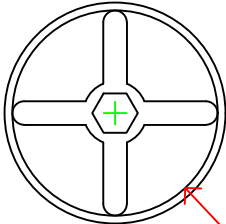

PF20 &
PF20/QC

3 1/4"

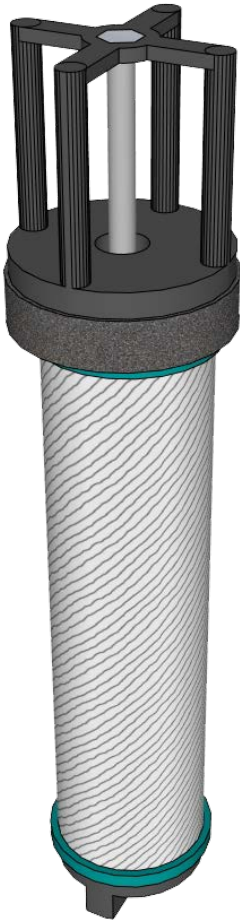
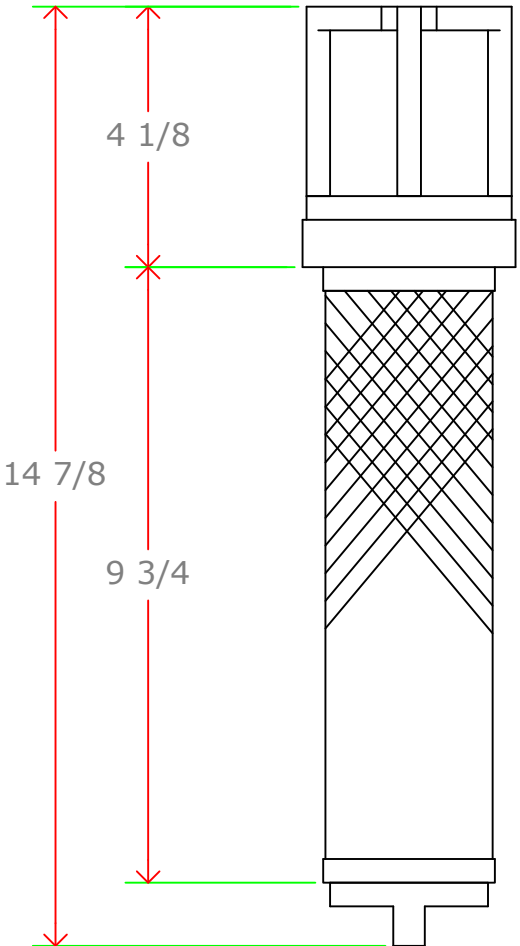
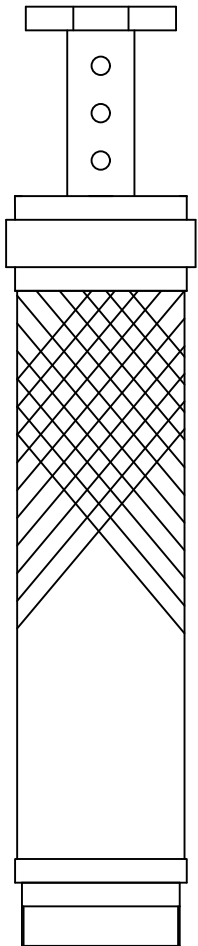

MATERIALS OF CONSTRUCTION:
STRING WOULD COTTON, RYTON

Capacity:	x	Gallons				
Max Temp.:	200	F				
Max Press.:	N/A	PSI				
Weight:	10	Lbs.				
Voltage.:	x	VAC	x	Phs	x	Hz
FLA.:	x	amps				
AquaPhoenix Scientific, Inc. California Division 113 Viking Ave, Brea CA 92821 Phone: 714-257-9165 http://www.aquaphoenixsci.com Fax: 714-257-9215 info@aquaphoenixsci.com						
Date:	02/01/06	Scale:	NTS	Rev.:	A	
Description: BYPASS/FILTER FEEDER ACCESSORIES						
Model: SW30 & SW30-QC						

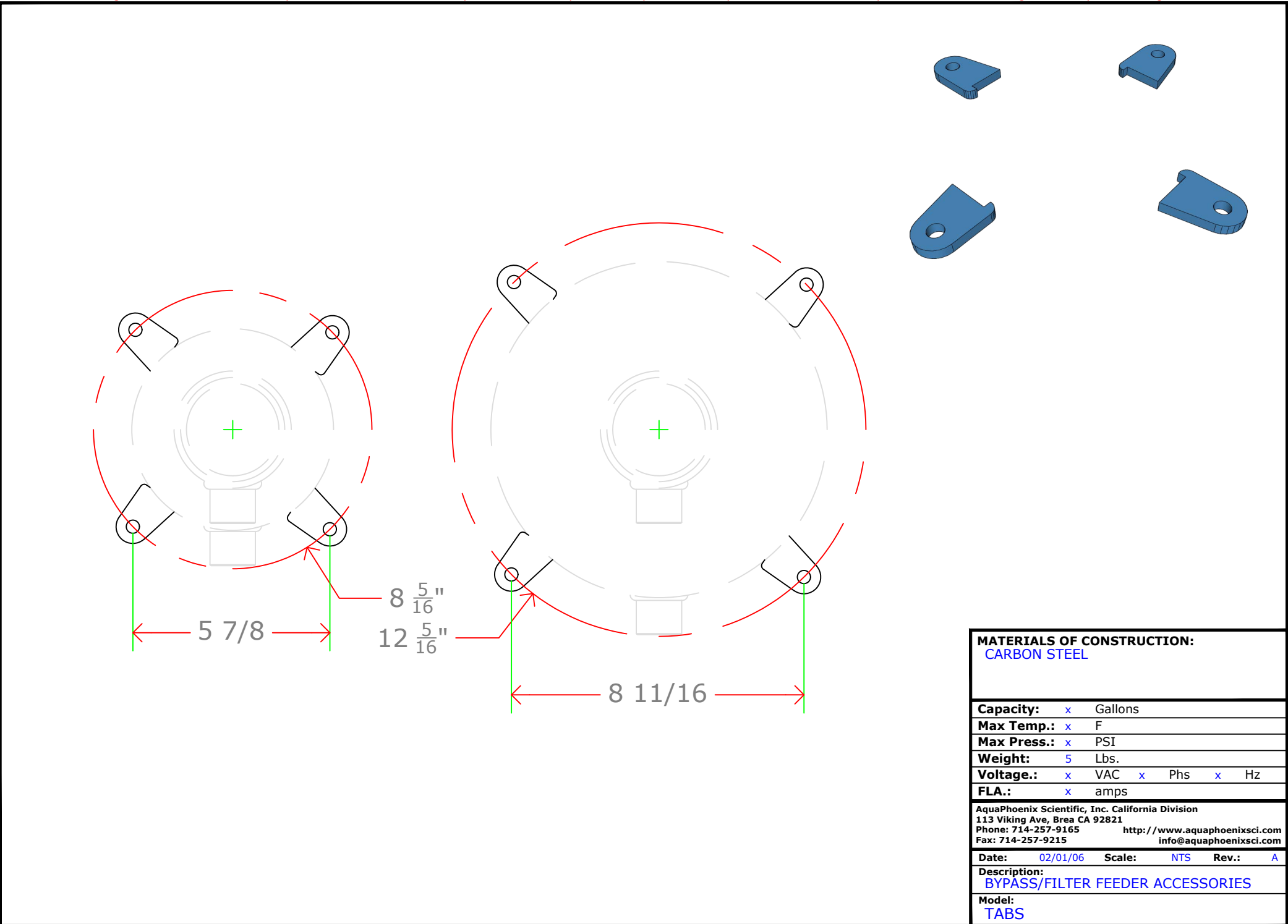

NOTICE: This drawing and it's contents are for the specific use of APS customers only. It is not to be duplicated or copied without expressed written consent. AquaPhoenix reserves the right to modify this drawing without notice.

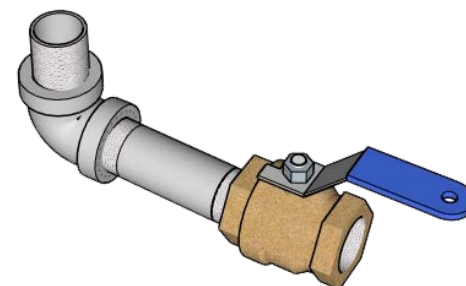
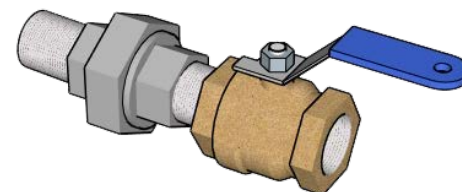
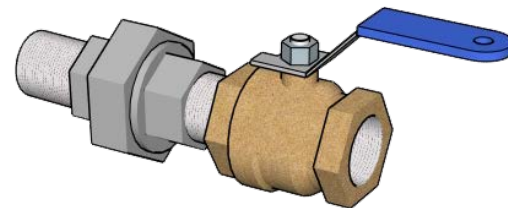
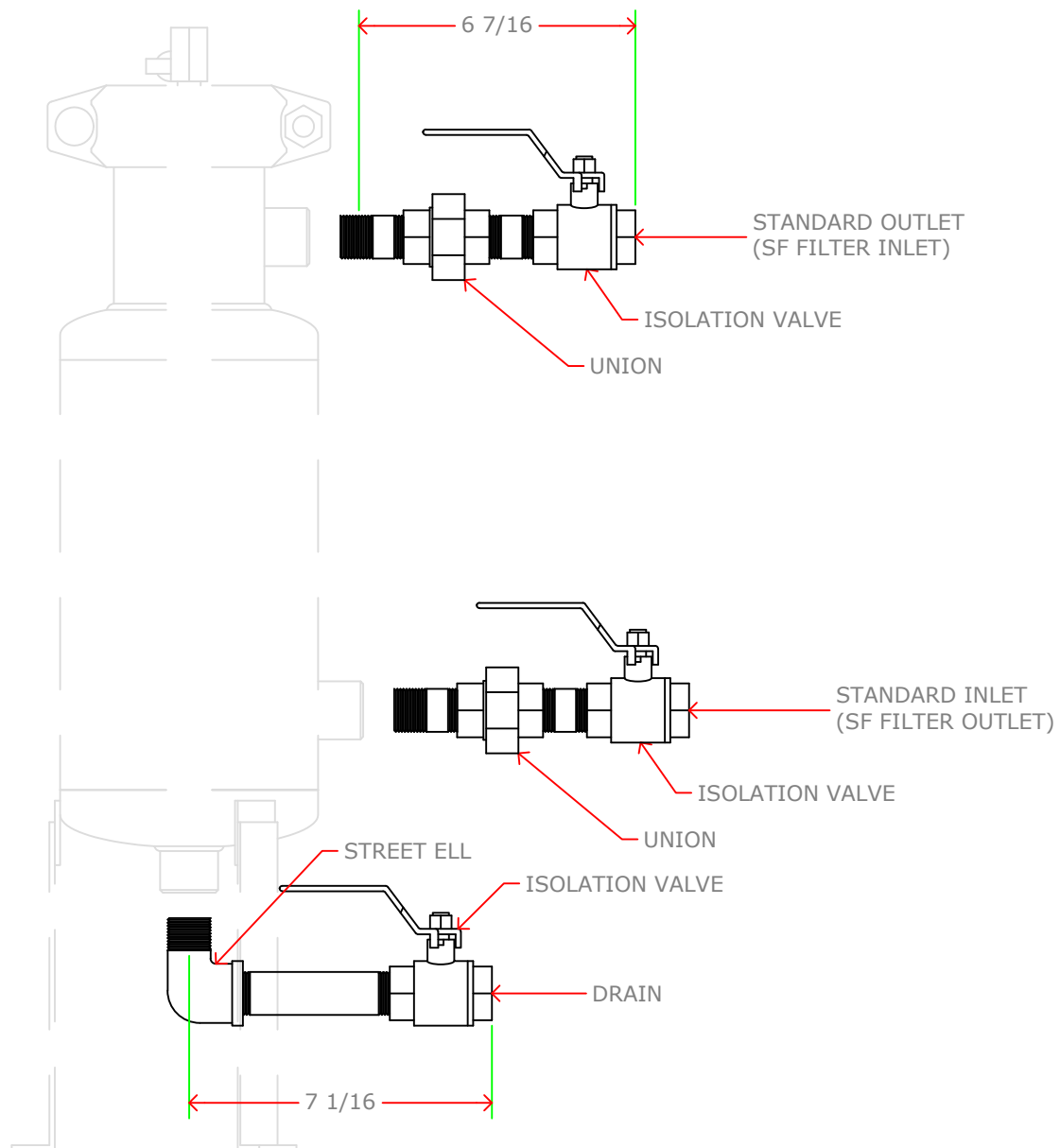

MATERIALS OF CONSTRUCTION:
CARBON STEEL, BRASS, DUCTILE IRON

Capacity:	x	Gallons				
Max Temp.:	200	F				
Max Press.:	300	PSI				
Weight:	10	Lbs.				
Voltage.:	x	VAC	x	Phs	x	Hz
FLA.:	x	amps				

AquaPhoenix Scientific, Inc. California Division
113 Viking Ave, Brea CA 92821
Phone: 714-257-9165 <http://www.aquaphoenixsci.com>
Fax: 714-257-9215 info@aquaphoenixsci.com

Date: 02/01/06 Scale: NTS Rev.: A

Description:
BYPASS/FILTER FEEDER ACCESSORIES

Model:
VPDB

NOTICE: This drawing and it's contents are for the specific use of APS customers only. It is not to be duplicated or copied without expressed written consent. AquaPhoenix reserves the right to modify this drawing without notice.

NOTICE: This drawing and it's contents are for the specific use of APS customers only. It is not to be duplicated or copied without expressed written consent. AquaPhoenix reserves the right to modify this drawing without notice.

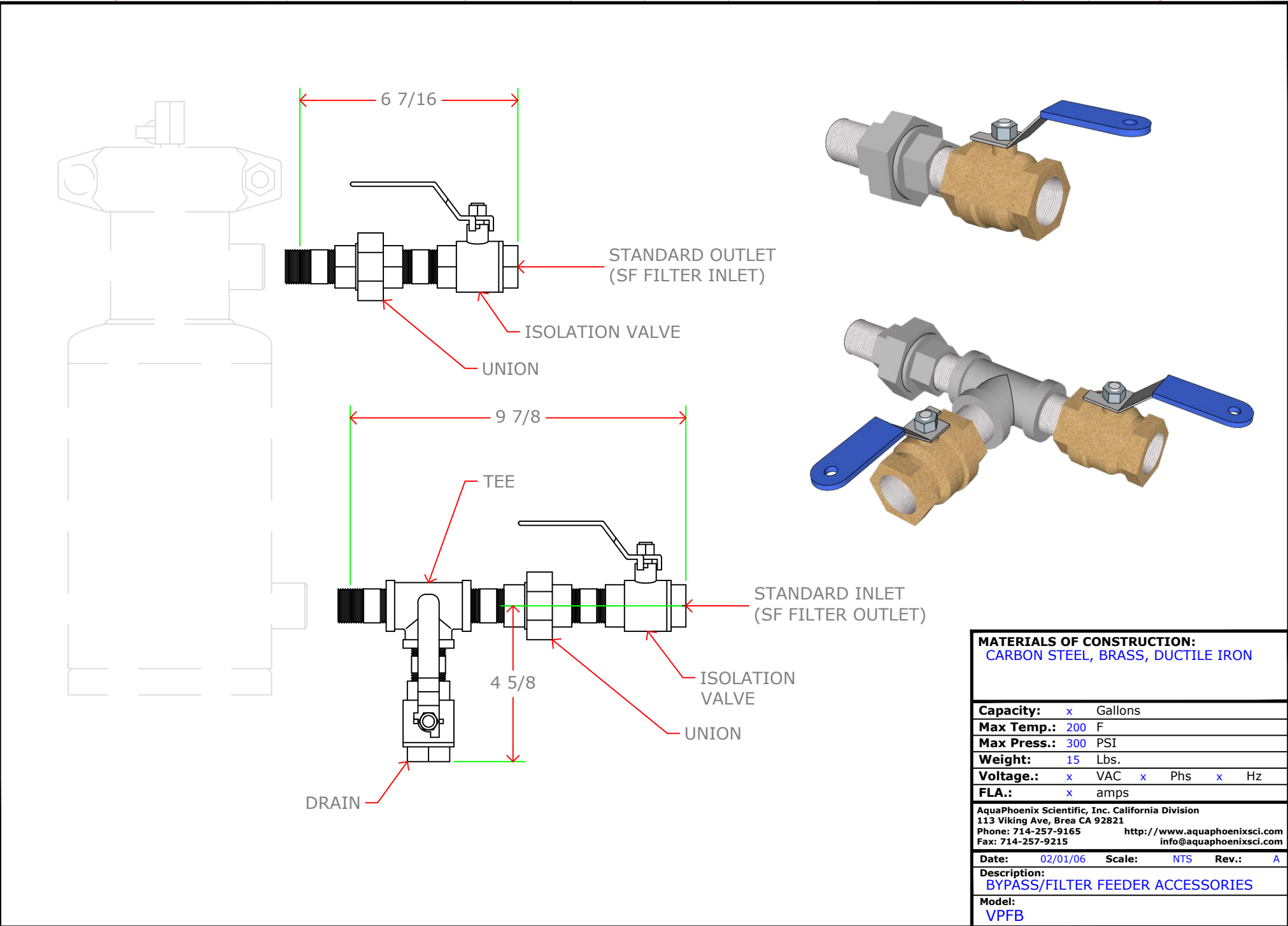

NOTICE: This drawing and it's contents are for the specific use of APS customers only. It is not to be duplicated or copied without expressed written consent. AquaPhoenix reserves the right to modify this drawing without notice.