

pH Test Kit

pH 3 – 10.5 (1.0 increments)

TK9905-Z
white caps

KIT COMPONENTS:

WR1250-B	Wide Range Indicator, 60 mL
0106	Test Tube square, w/cap
CP-0020-DR	Dropper, 0.5-1.0 mL
2193-01	Wide Range pH 3.0-6.5 Octa-Slide 2 Bar
2196-01	Wide Range pH 7.0-10.5 Octa-Slide 2 Bar
1101	Octa-Slide Viewer

INTERFERENCES: Turbid or highly colored samples may mask the color change at the endpoint.

ATTENTION: As necessary, calibrate this kit against a known standard made with plant / make-up water. Be sure to collect a representative sample.

SAFETY TIPS:



Wear
Gloves



Use Eye
Protection



Read
SDS

TESTING TIPS:



Collect
Accurate
Sample



Hold
Bottles
Vertically



Ensure
Proper
Lighting

USE OF THE OCTA-SLIDE 2 VIEWER

The Octa-Slide 2 Viewer should be held so non-direct light enters through the back of the Viewer. Insert the reacted sample into the top of the Viewer. Slide the Octa-Slide 2 Bar into the Viewer and match the color of the reaction to the color standards.



1 Rinse test tube three times with sample to be tested. **Fill test tube to the 10 mL line.**

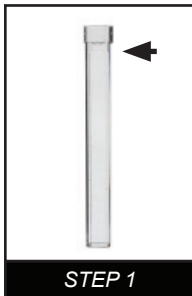

2 Add 12 drops of **Wide Range Indicator (WR1250)**. Cap and mix.



3 Insert **Wide Range pH 3.0-6.5 Octa-Slide 2 bar (2193-01)** or the **Wide Range pH 7.0-10.5 Octa-Slide 2 Bar (2196-01)** into the Octa-Slide 2 Viewer (1101).

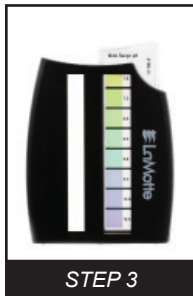

4 Insert **test tube** into Octa-Slide 2 Viewer.

Match the color of the test tube to the color standard. Record as pH units.

